

35-112 Removal and installation of tie rod, replacement of rubber mount

Preceding work:
Removal, installation of wheels 40-110.

Operation no. of operation texts and work units
or standard texts and flat rates:
35-0056, 35-0057, 35-0058

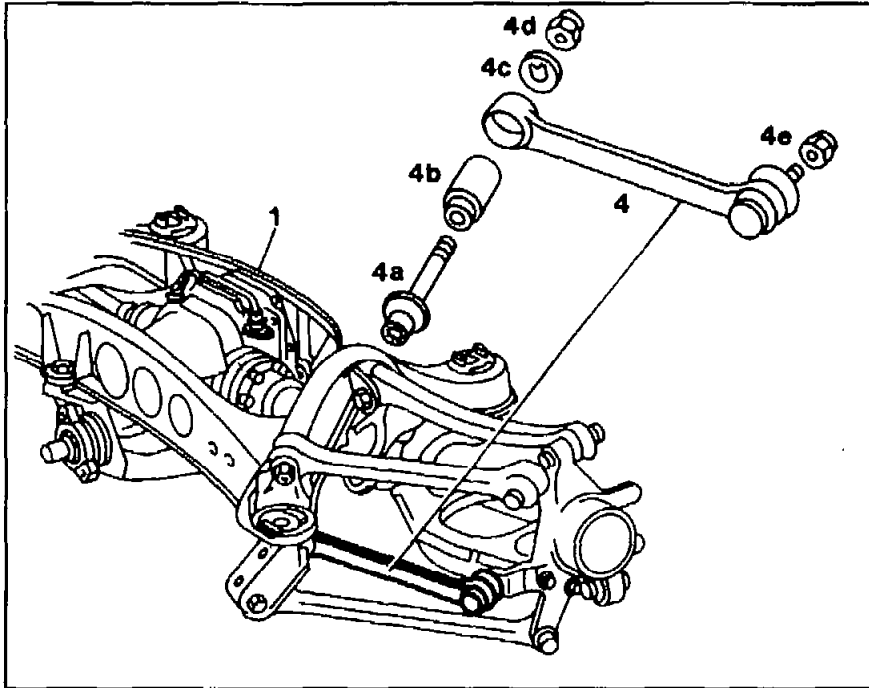

P35-5490-35

Tie rod (4) on wheel carrier

Loosen, replace self-locking hexagon nut (4e).
Using puller 201 589 01 33 00 and thrust piece
201 589 05 63 00, press tie rod (4) out of wheel
carrier. Clean conical seat of ball pin in wheel
carrier. Press ball pin of tie rod firmly into wheel
carrier. Steady using hexagon socket wrench,
and tighten self-locking hexagon nut to 35 Nm
(numbers 1, 2 and 3).
Torque wrench 001 589 72 21 00.

Tie rod (4) on rear axle bracket	Mark position of eccentric (4a) to rear axle bracket (number 4). Loosen, replace, tighten self-locking hexagon nut (4d), 70 Nm. Remove eccentric washer (4c) and eccentric bolt (4a). <i>Only tighten self-locking hexagon nut when rear axle shaft is horizontal.</i> Note markings of eccentric bolt or rear axle bracket (number 5). Torque wrench 001 589 66 21 00.
Rubber mount (4b)	Remove, replace, install using extractor/pulling-in equipment 124 589 02 43 00 (number 6).
Rubber cup seal and ball joint of tie rod	Check, replace complete tie rod if required.
Toe-in of rear axle	Check, adjust if required (40–330).

Special tools

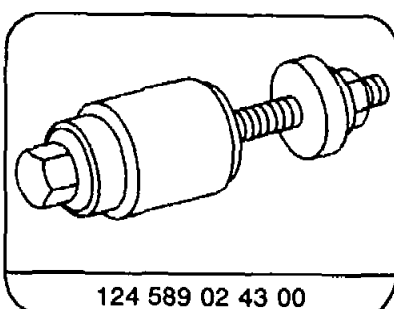
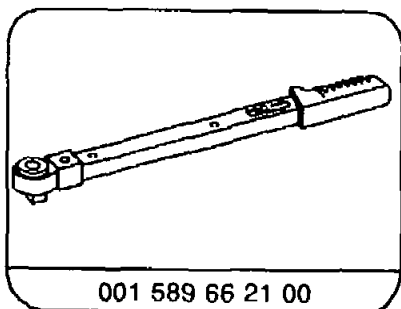
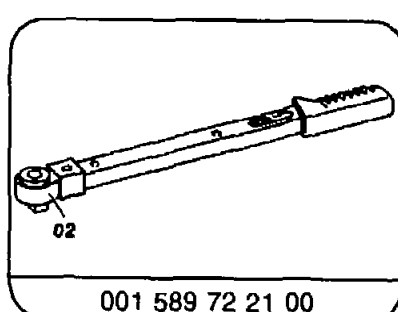
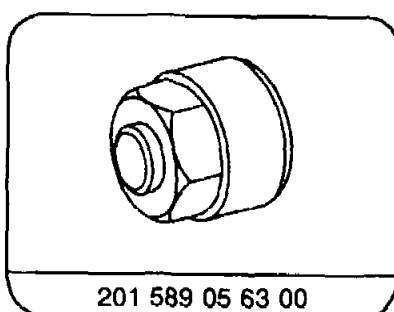
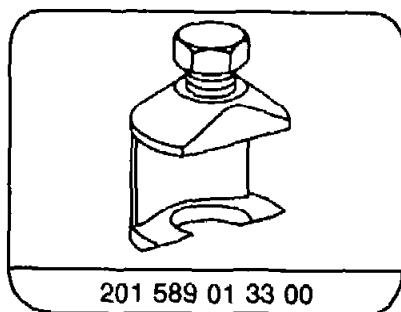

Removal, installation

- 1 Unscrew self-locking hexagon nut on wheel carrier and remove.
- 2 Screw thrust piece 201 589 05 63 00 on to thread.

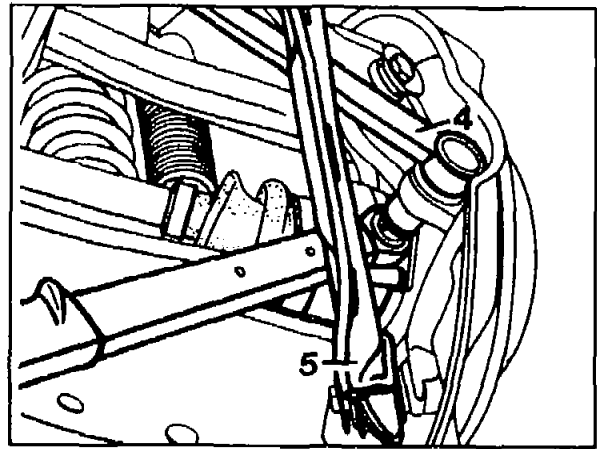

P35-5491-13

- 3 Using puller (04) 201 589 01 33 00, press tie rod out of wheel carrier.

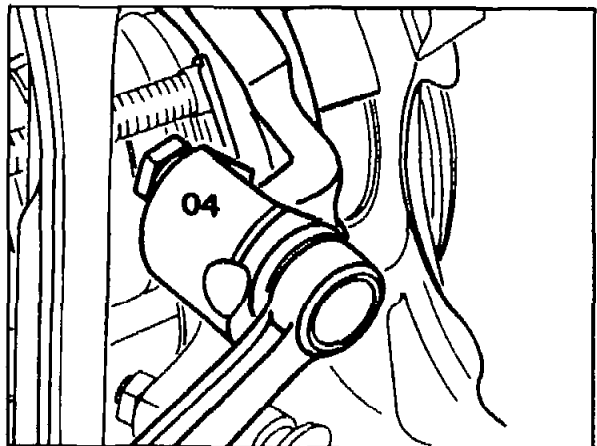

P35-5492-13

Installation note

Replace self-locking hexagon nut. Remove grease from ball pin and conical seat in wheel carrier. Press ball pin securely into taper of wheel carrier, screw on self-locking hexagon nut whilst steadying ball pin using hexagon socket wrench (04a). Tightening torque 35 Nm. Torque wrench 001 589 72 21 00.

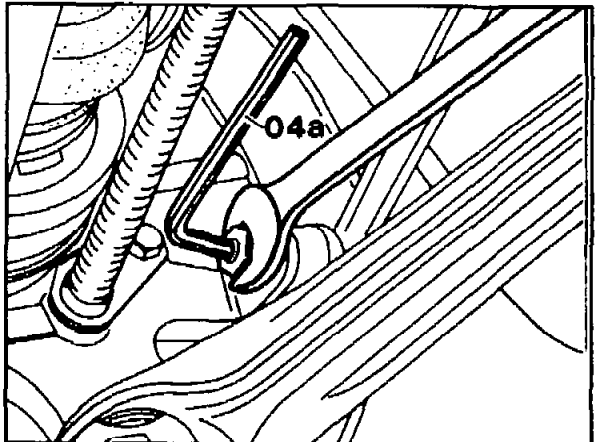

P35-5493-13

- 4 Mark position of eccentric bolt (4a) to rear axle bracket (1) (arrow).

Installation note

Mount eccentric bolt as marked.

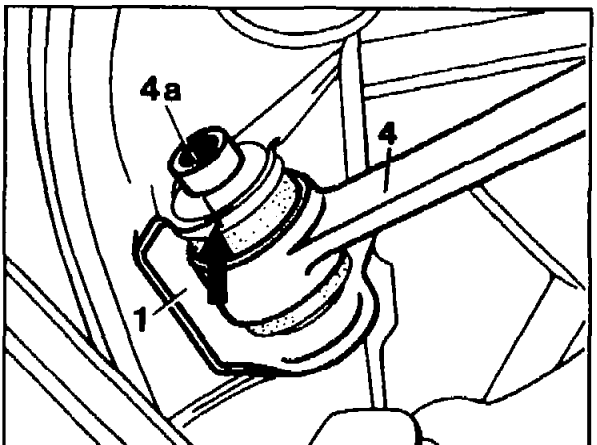

P35-5494-13

5 Unscrew self-locking hexagon nut and remove complete with eccentric washer, eccentric bolt (4a) and tie rod (4).

Installation note

Replace self-locking hexagon nut. Only tighten when rear axle shaft is horizontal. Tightening torque 70 Nm.

Torque wrench 001 589 66 21 00.

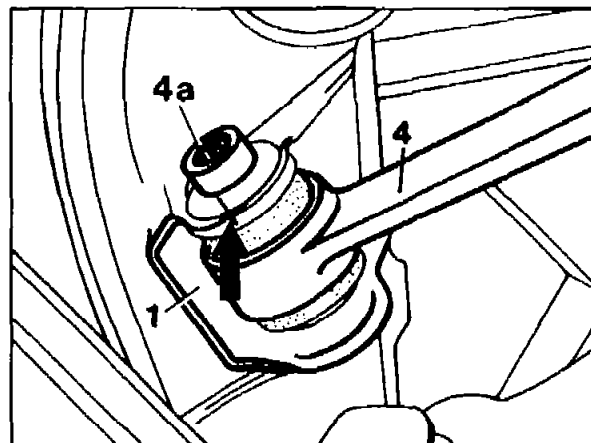

P35-5495-13



When raising one side of the rear axle until the rear axle shaft is horizontal, ensure that the vehicle does not lift off the supporting surface of the hoist - risk of accident.

If necessary, load up the trunk.

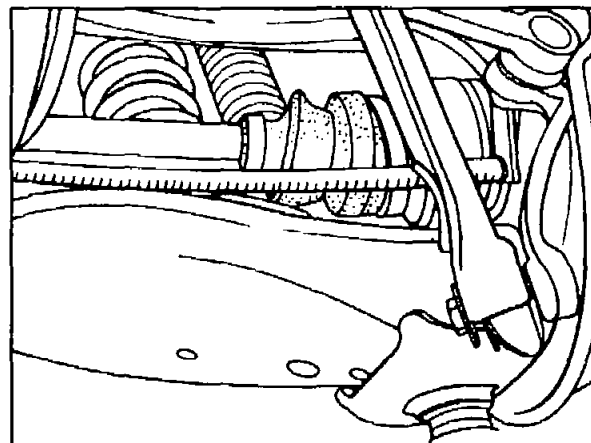

P35-5480-13

Testing

Replace damaged rubber mounts and if the rubber cup seal is damaged or the ball joint is worn, replace tie rod.

Replacement of rubber mount

6 Using extractor (04a-04d) 124 589 02 43 00 pull rubber mount (4b) out of tie rod (4).

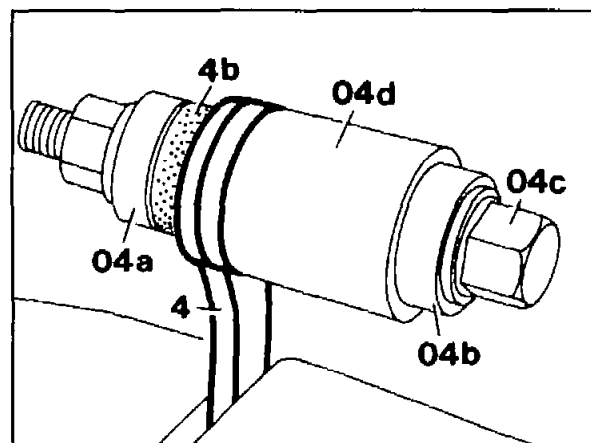

P35-5496-13

- 4 Tie rod
- 4b Rubber mount
- 04a Pressure ring
- 04b Thrust washer with axial needle bearing
- 04c Hexagon bolt with hexagon nut
- 04d Sleeve



Installation note

Using pulling-in equipment (04a-04d) draw rubber mount (4b) into the tie rod until the spacer (04a) contacts the eye on the tie rod.

- 04a Spacer
- 04b Thrust washer with axial needle bearing
- 04c Hexagon screw with hexagon nut
- 04d Sleeve
- 4 Tie rod
- 4b Rubber mount

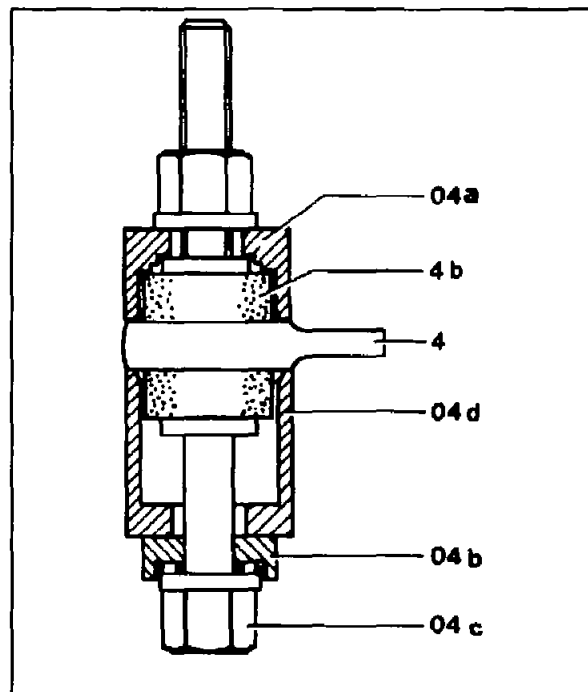

P35-5497-15

7 Check toe-in of rear axle, adjust if required (40-330).

8 Install in reverse sequence.