

# 15-7101 Servicing starter (model 124.1, 124.3 as of approx. 11/88)

Preceding work:  
Removing starter (15-7100)

Operation no. of operation texts and work units or standard texts  
and flat rates:

## A. Replacing hollow gear

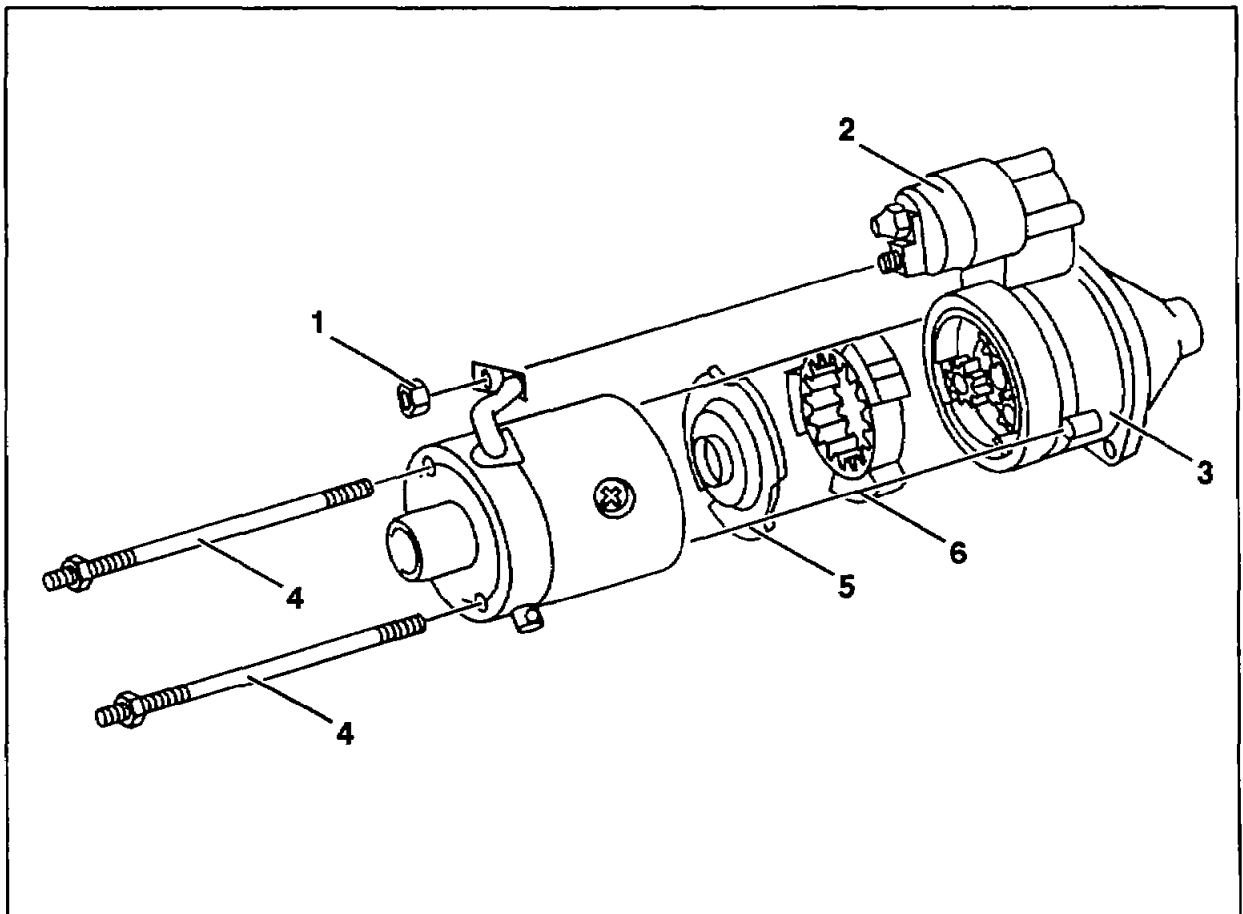

P15.30-0225-57

- |   |  |
|---|--|
| Connection for exciter winding at solenoid switch (2) ..... | disconnect, connect.   |
| Drive gear (3) with planetary gear .....                    | Unscrew nut (1) at solenoid switch (2), screw on for this step.<br>take off, fit on. |
| Cover plate (5) .....                                       | Unscrew bolts (4), screw in for this step.<br>take off, fit on.                      |
| Hollow gear (6) .....                                       | take out, insert.  |

**Note**

Coat special grease (included in part supply) into the splines.

## B. Replacing planetary gear

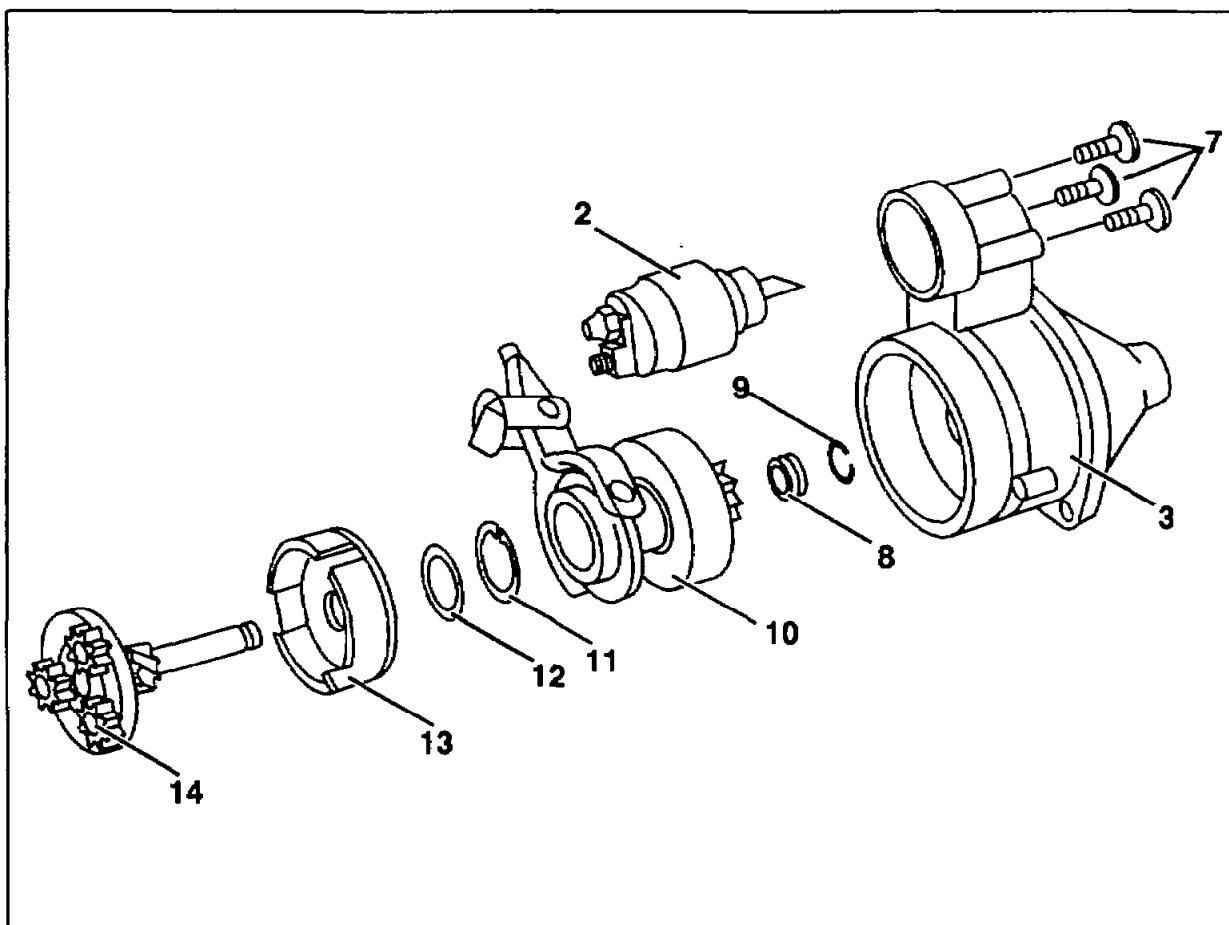

P15.30-0224-57

Planetary gear (14) ..... inspect.

### Note

Non-damaged planetary gear should be cleaned dry (cloth/ compressed air). Do not use any liquid cleaning products.

Damaged planetary gears should be replaced complete.

Solenoid switch (2) ..... remove, install.

Remove screws (7), insert for this step.

Planetary gear (14) and starter pinion (10)  
with engaging lever ..... pull out of drive bearing housing (3), press in.

Circlip (8) ..... press off from spring lock washer (9), press on.

### Note

Press off circlip (8) toward planetary gear.

Spring lock washer (9) ..... pull out of groove, insert.

**Note**

Before the circlip (8) can be pressed onto the spring lock washer (9) when installing, the spring lock washer has to be compressed in the groove with a suitable tool.

Starter pinion (10) with engaging lever ..... pull off, fit on.

Circlip (11) and washer (12) at housing of planetary gear (13) ..... take off, fit on.

Planetary gear (14) ..... remove from housing of planetary gear (13), insert.