

## 05-3300 Removing and installing tensioning rail

Preceding work:  
Timing case cover removed (01-2100).

Operation no. of operation texts and work units or standard texts  
and flat rates  
05-8121

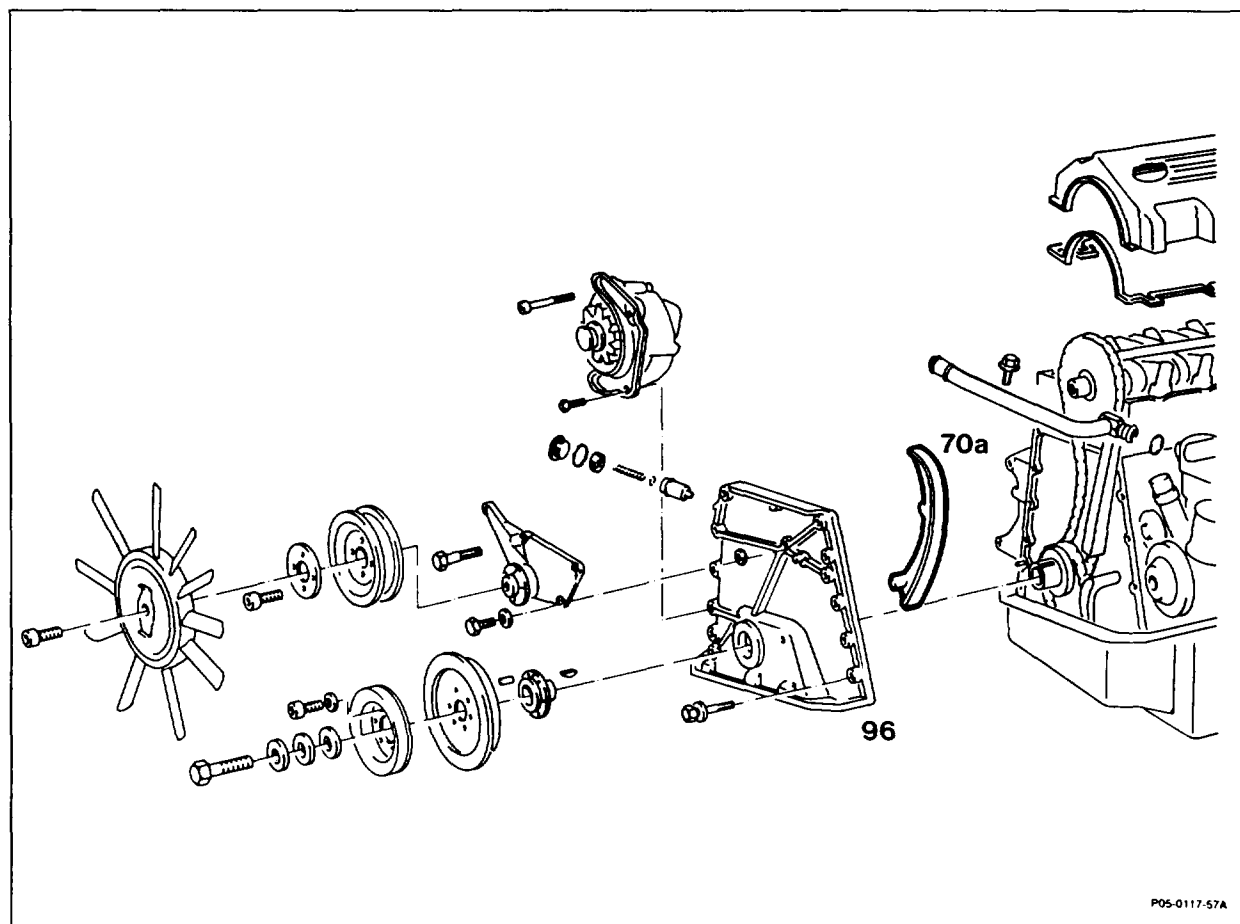

Timing chain with crankshaft gear .....	mark (step 1).
Tensioning rail (70a) .....	remove, install (step 2).
Setting of camshaft .....	check.
Installation .....	in the reverse order.

## Removal, installation

- 1 Mark timing chain with crankshaft gear (arrows).
- 2 Take off tensioning rail (70a).

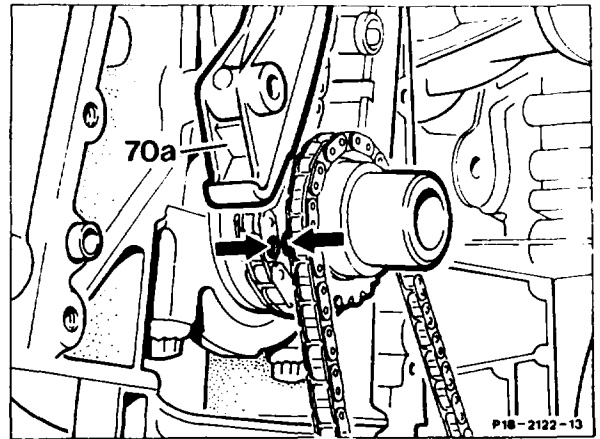

## Installation instruction

Position piston of cylinder 1 to TDC (arrow).

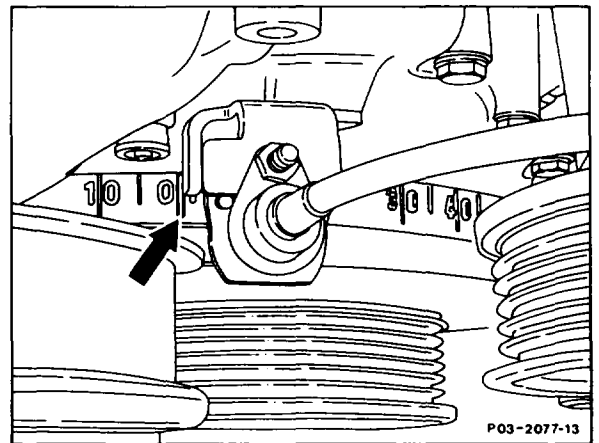

Position marking (22) or position hole of camshaft must be aligned with the marking (517) on 1st camshaft bearing.

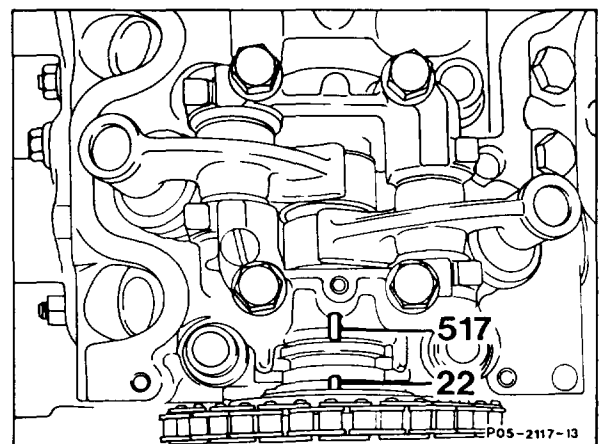

Effective 12/86 a positioning hole (21) is provided in place of the pin (22).

Installation is performed in the reverse order.

