

05-2170 Removing and installing driver on camshaft

Preceding work:
High voltage distributor removed (15-3010)

Operation no. of operation texts and work units or standard texts
and flat rates

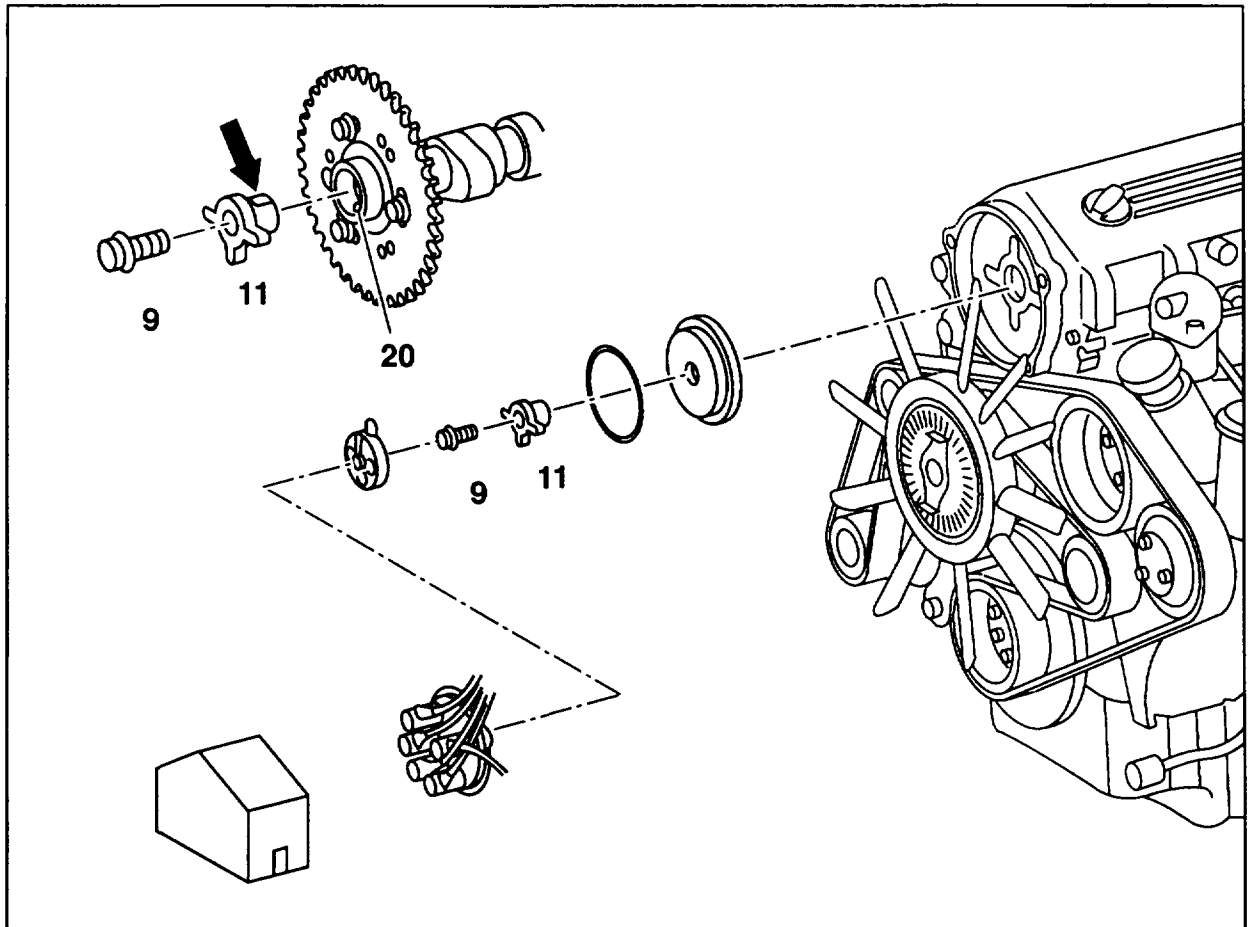

P05-5505-57

Distributor rotor (11) unscrew, screw on.



Pay attention to tightening torques of different versions of bolts (9); see table overleaf.
Installation note: the slot (arrow) in the driver (11) must engage over the locating pin (20) in the camshaft.



Special tool

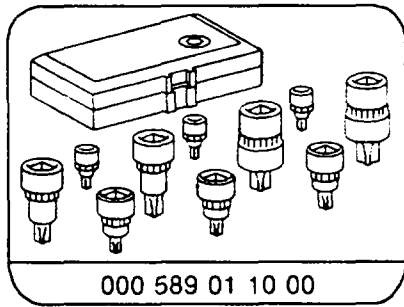

Driver	1st version up to 02/1989	2nd version as of 03/1989	3rd version
Material	Aluminium	Steel	Steel
Bolt	M8 × 29	M7 × 29 (internal torx)	M7 torx T40
Tightening torque	21 Nm	16 Nm	16 Nm
Insertion sleeve	103 589 00 14 00	103 589 01 14 00	103 589 01 14 00
Collar Ø	21.5 mm	20 mm	20 mm

