

05-2152 Adjusting camshaft timing

Preceding work:

Camshaft timing checked (05-2150).

Front cover at top removed (01-2120).

Camshaft sprocket 1st version up to 10/1985 and engine 103.983 AMG

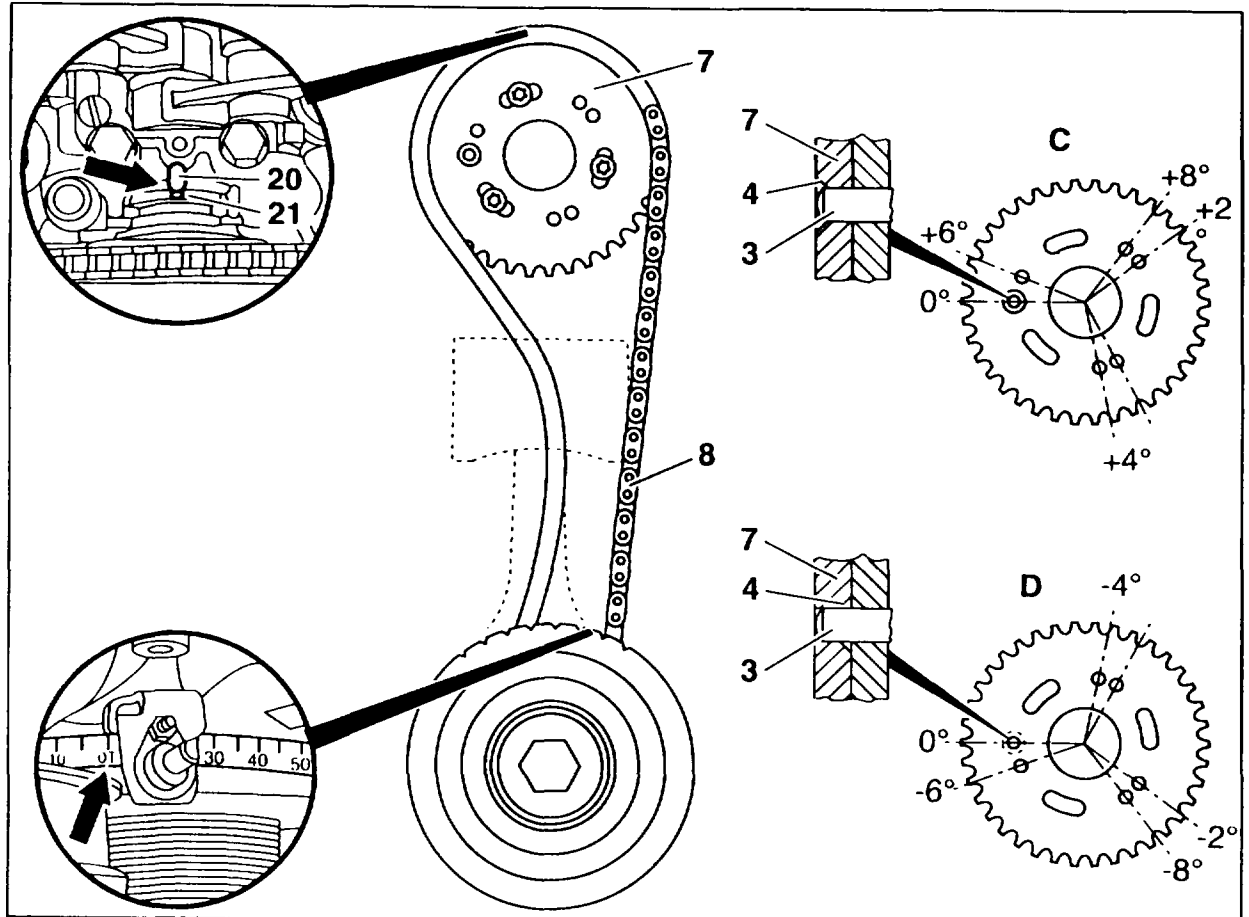

P05-5512-57

- 3 Locating pin in camshaft flange
- 4 Adjusting hole with chamfer at front, or rear for basic setting
- C Timing advanced (+2°, +4°, +6°, +8°) as chamfer at adjusting hole (4) at front
- D Timing retarded (-2°, -4°, -6°, -8°) as chamfer at adjusting hole (4) at rear (camshaft sprocket (7) turned)

Camshaft	rotate into basic position (05-2230)
Chain tensioner	remove (05-3100)
Camshaft sprocket (7)	unbolt, remove from camshaft (05-2200)

Adjusting timing in basic setting

Camshaft sprocket (7) rotate until locating pin (3) engages in the hole (4) with the chamfer facing forward or to the rear

Advancing timing (+2°, +4°, +6°, +8° crank angle)

Camshaft sprocket (7) turn so that chamfer of bore (4) is facing forward

Camshaft sprocket (7) rotate with timing chain (8) fitted on until locating pin (3) engages in the corresponding hole (+2°, +4°, +6°, +8°)

Retarding timing (-2°, -4°, -6°, -8° crank angle)

Camshaft sprocket (7) turn so that chamfer of hole (4) is facing to the rear

Camshaft sprocket (7) rotate with timing chain (8) fitted on until locating pin (3) engages in the corresponding hole (-2°, -4°, -6°, -8°)

Chain tensioner install (05-3100)

Camshaft timing check (05-2150)

Camshaft sprocket 2nd version (as of 10/1985)

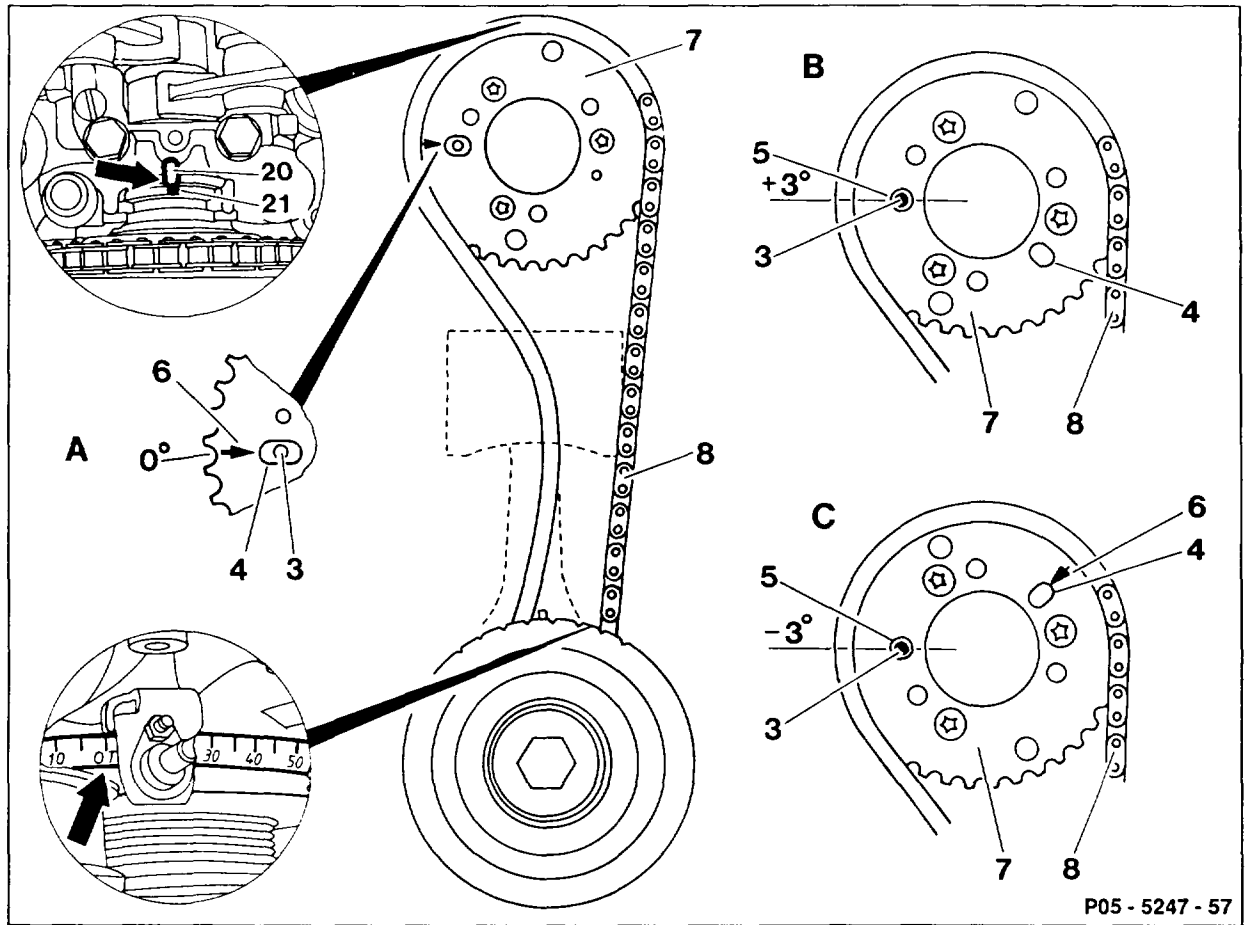

- A Basic position
 B Camshaft timing advanced 3°
 C Camshaft timing retarded 3°

Camshaft	rotate into basic position (05-2230).
Chain tensioner	remove (05-3100).
Camshaft sprocket (7)	unscrew, remove from camshaft (05-2200).
Advancing timing by 3° crank angle (B)	
Camshaft sprocket (7)	turn (arrow (6) rear).
Camshaft sprocket (7) with timing chain (8) fitted	install, hole must engage in locating pin (3).

Retarding timing by 3° crank angle (C)

Camshaft sprocket (7) (arrow (6) front) with timing chain (8) fitted	install, hole must engage in locating pin (3).
Camshaft sprocket (7)	screw on (05-2200).
Chain tensioner	install (05-3100).
Camshaft timing	check (05-2150).

Special tool

