

03-5000 Removing and installing holding lock for crankshaft/ring gear

Preceding work:

Bottom engine compartment panel removed
(Maintenance Manual Volume 2, Op. no. 6190).

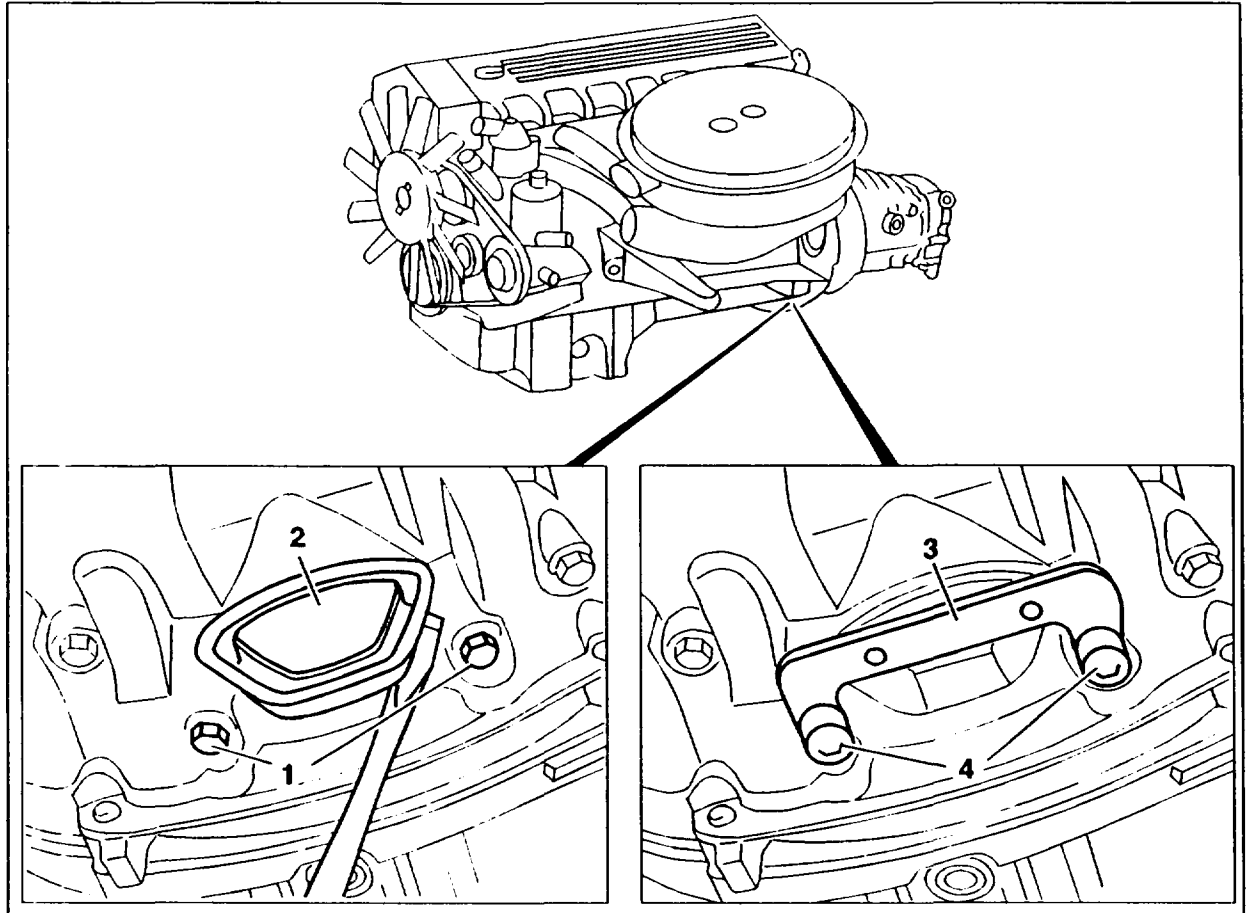

P03-5355-57

Plastic cap (2) on rear of sump	take off, fit on.
M6 x 85 bolts (1)	unscrew, screw on (10 Nm).
Holding lock (3) 601 589 02 40 00	allow to engage in ring gear, rotate crankshaft if necessary.
Holding lock (3)	unscrew, screw on (10 Nm).
	⚠
	Bolt on holding lock (3) with M6 x 90 bolts (4) (part of special tool) otherwise the threads in the rear end cover will be damaged.