

01-3100 Removing and installing oil sump (except 4MATIC)

Preceding work:

Hood raised to vertical position (01-0080).
 Bottom engine compartment panel removed (Maintenance Manual Volume 2, Op. no. 6190).
 Front axle on model 107 removed (33-1000).
 Air cleaner removed (09-1031).
 Fan shroud removed (20-3400).

Operation no. of operation texts and work units or standard texts and flat rates
 01-7500

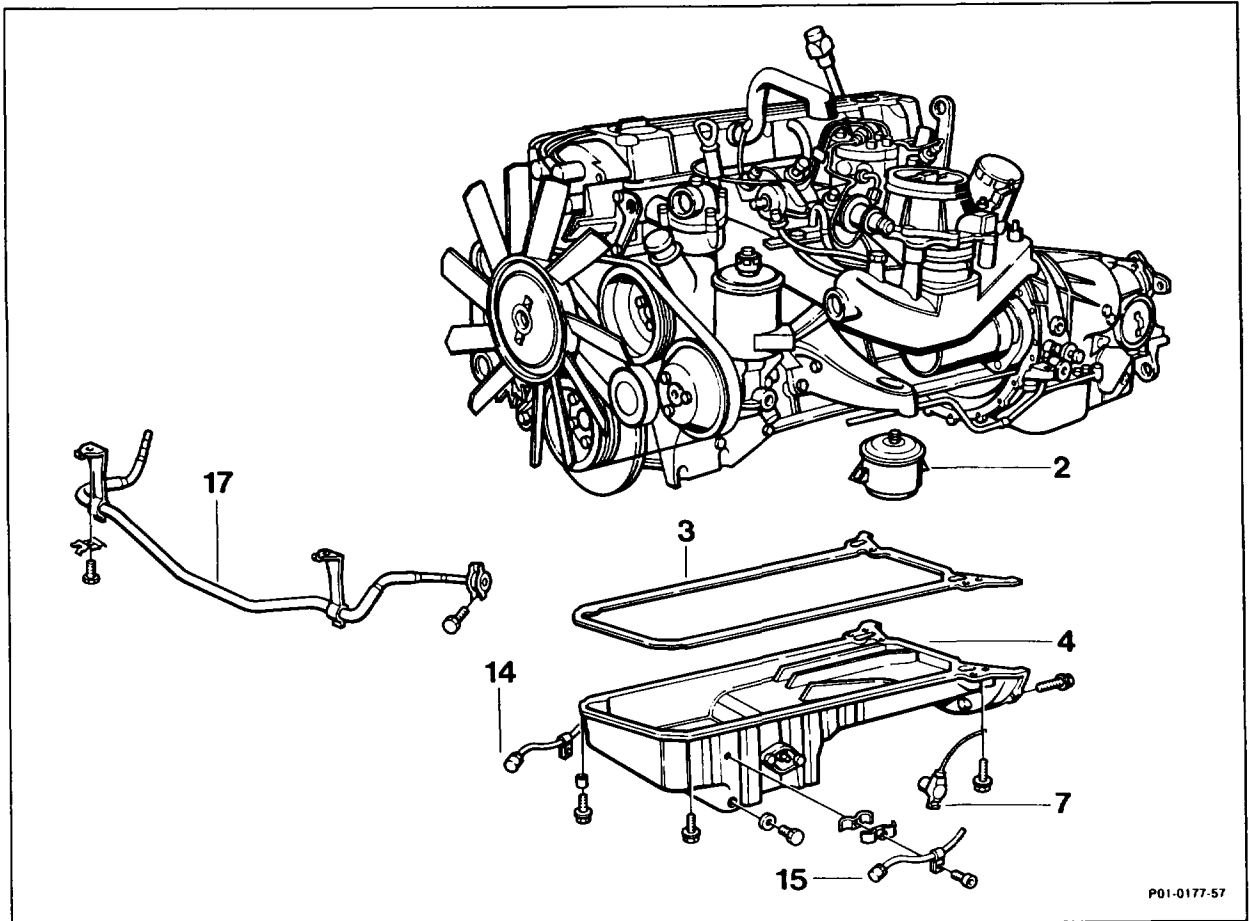

P01-0177-57

Ground cable at battery	disconnect, connect
Engine oil	drain, pour in (18-0020)
Front engine mounts (2)	unbolt from below, bolt on (22-2110)
Model 107, 126: engine shock absorber	remove, install (22-2400)
Plug connection of oil level sensor (7)	unplug at oil sump, plug in
Plug connection of oil pressure switch	unplug, plug in
Automatic transmission: oil pipes (14, 15) at oil sump	unbolt, bolt on
Model 129: oil cooler pipes at oil sump (4)	unbolt, bolt on



Models 126, 201: oil pipe of level control	unbolt at oil sump (4), bolt on
Models 129, 201: torsion bar (17)	remove, install (32-300)
Models 129, 201: left drag link with steering damper	unbolt, detach and turn to the rear right, bolt on (46-550)
Guard plate	insert at component compartment wall
Engine	raise
Oil sump	unbolt at crankcase, bolt on. M6 bolts 10 Nm, M8 bolts 21 Nm, M10 bolts 40 Nm
Oil sump (4)	remove downward to the front
Gasket of oil sump (3)	replace



Before tightening the oil sump bolts, aline oil sump (4) to the rear contact surface on the transmission, allow to rest on surface.

Engine run and check for leaks

Tightening torques in Nm

Oil sump to crankcase	
M6 hexagon bolts	10
M8 hexagon bolts	25
M10 hexagon bolts	40
Oil pipes at oil sump	10

Special tool

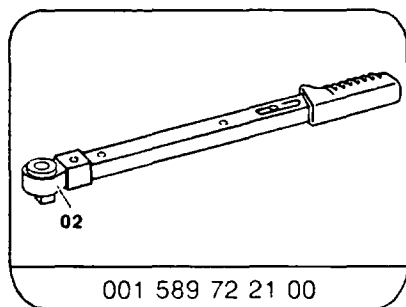

Shop-made tools

Metal panel for component compartment wall	Dimensions: approx. 320 × 380 × 1
--	-----------------------------------

Guard plate for radiator/condenser	Dimensions: approx. 480 × 600 × 1
------------------------------------	-----------------------------------

