

01-2220 Removing and installing closing cover

Preceding work:

Manual or automatic transmission removed (26-020 or 27-600), and flat rates

Manual transmission: flywheel removed (03-4100) or two-mass flywheel removed (03-4620).

Automatic transmission: driven plate with ring gear removed (03-4100)

Operation no. of operation texts and work units or standard texts

01-8913

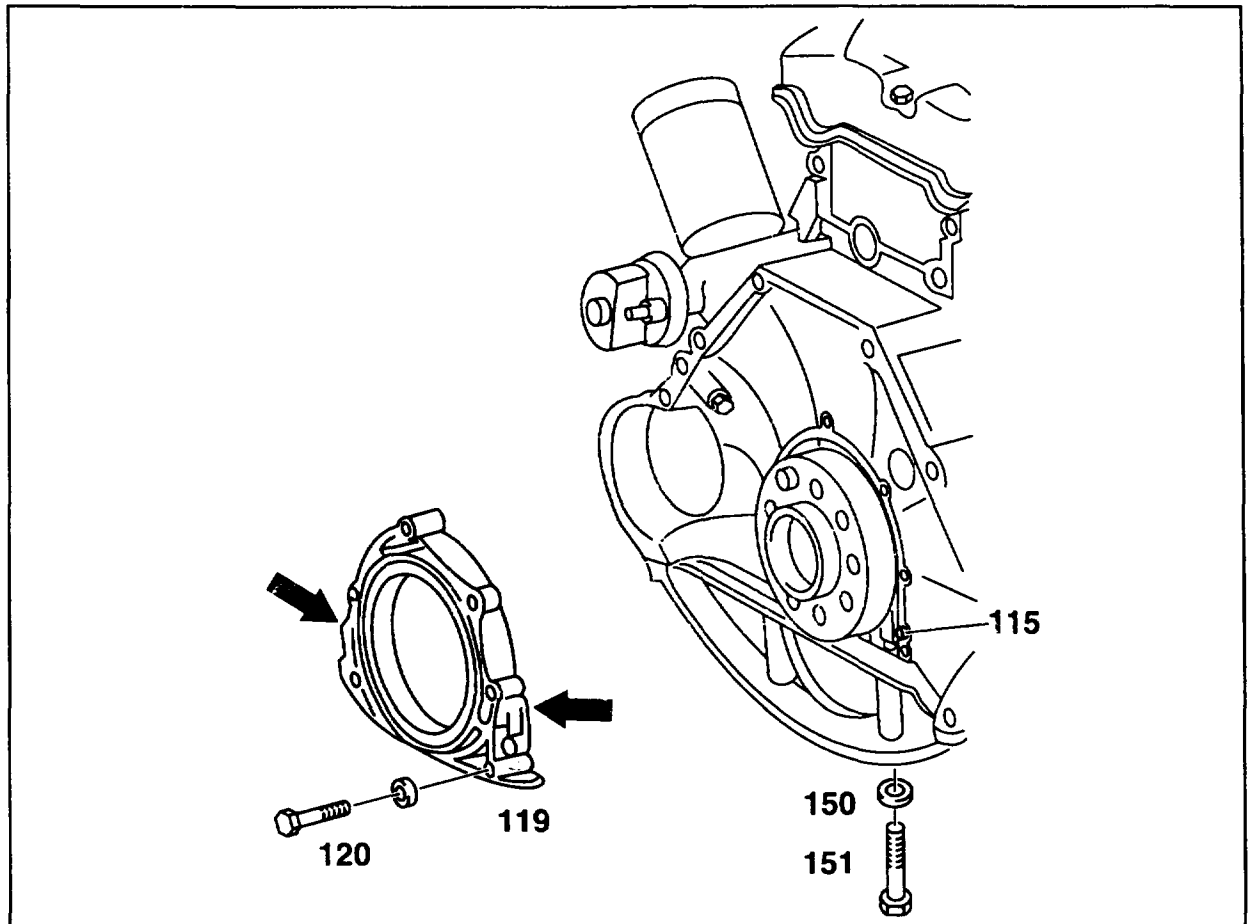

P01-6049-57

Bolts (120 and 151) unscrew, screw on (10 Nm)



Tighten bolts (120) first when installing. Pay attention to spring washers (150).



Closing cover (119)	remove, install. Press off at shoulders (arrows). Push closing cover (119) over inner part of insertion tool 601 589 03 43 00.
	<p style="text-align: center;">⚠</p> <p>Do not damage gasket of oil sump. Pay attention to gasket of oil sump. On 4MATIC engines: seal oil sump with sealant 001 989 61 20 10.</p>
Contact surface of radial seal on crankshaft	examine. If contact surface has grooves, remove radial seal (03-3270) and install repair size radial seal with sealing lip offset to the inside.
Sealing surfaces	clean and coat with sealant 001 989 45 20 10.
Sealing surfaces	clean.
Dowel pins (115)	do not lose.
Radial seal	examine, replace if necessary (03-3270). Coat sealing lip with engine oil.
	<p style="text-align: center;">⚠</p> <p>Do not use grease! Grease prevents the sealing lip of the radial seal transporting back the engine oil.</p>
Rear of engine	check for leaks (01-2240).

Special tools

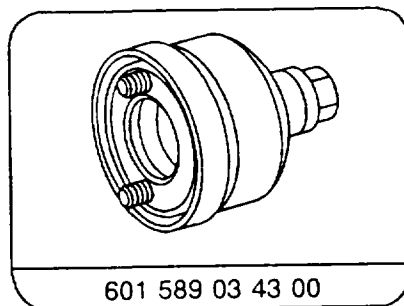
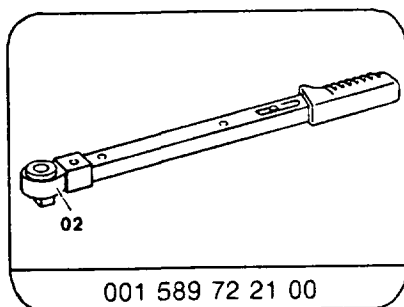

Note

The closing cover is sealed on the crankcase with sealant and centered with 2 dowel pins. In addition, it is bolted to the oil sump and sealed down the way by the oil sump gasket, or on 4MATIC engines with sealant.

There must not be any scoring or unevennesses in the sealing surface of the closing cover and of the crankcase.

